

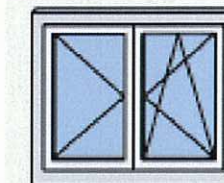

French casement window Tilt & Turn  
 SRW 280 - 800 for second opening Sash,  
 SRW 280 - 1300 for first opening Sash  
 SRH 500 - 2350  
 Koemmerling Gold



Nº	Turn only top hinge	Nº	Shootbolt top
52462	for PVC (5)	52505	Eurogroove 6/8/4 (18)
		41263	Spacer bar

20	Corner El.		
Nº			
52513	A	431 - 1650	370 - 2350
52514	B	280 - 430	370 - 2350
54796	C for night vent	400 - 1650	370 - 2350

Nº	Sissor Stay Hinge PVC
52480	with positioning pin 3mm silver (7)
52486	Rebated Sissor Stay Arm 12/20-13 (6)
94491	Spindle Bar (8)

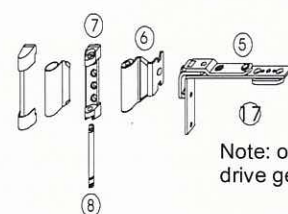

Note: over SRW 800mm you have to use french casement drive gears. Assembly shootbolt with centre look is not possible

Nº	Striker plates
34610	Striker (15)
95075	Sash lifter (16)

Nº	Compressed Middle Hinge
52480	Sissor Stay Hinge (7)
52486	Rebated Sissor Stay A. (6)
94491	Spindle Bar (8)
52321	Tilt only Hinge adjustable (26)
	or
94030	Til only Hinge for PVC Fix (27)
Nº	Option for windows Universal Compression device
52467	Sash Part (12)
35971	Frame part Koemmerling Gold (13)

Note: SRH 800 - 1750mm 1 Middle Hinges  
 SRH 1750 - 2350mm 2 Middle Hinges

Nº	Shootbolt bottom
52504	Eurogroove 6/8/4 (17)
41263	Spacer bar

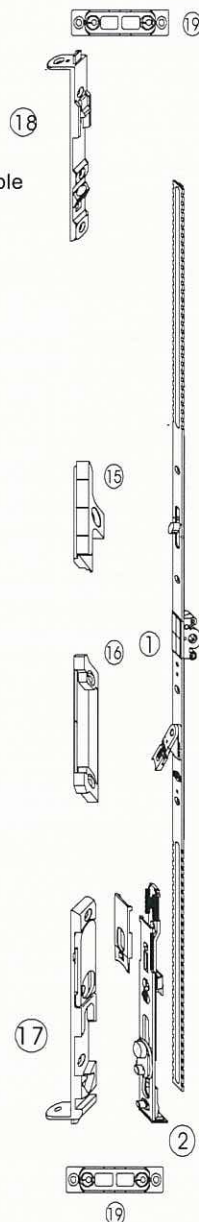
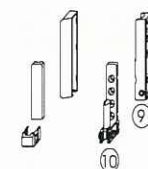
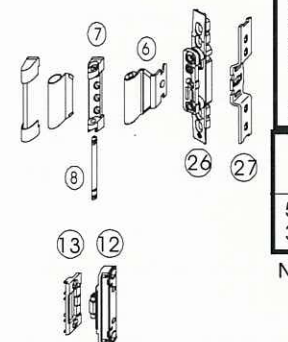

21	Rebated Sissor Stay		
Nº	Size	FFB mm	A B
52443	00	280 - 310	Corner Element B
52443	00	400 - 430	Corner Element A+C
52444	0	311 - 500	Corner Element B
52444	0	431 - 600	Corner Element A+C
52445	1	601 - 800	Corner Element A+C
52446	2	801 - 1050	Corner Element A+C
52447	3	1051 - 1300	Corner Element A+C
52448	4	1301 - 1400	Corner Element A+C

24 Note: over SRW 1400 mm window (door 1100mm) or sash weight over 100 kg you must also use stabilizing stay 10596, Striker 54639

1	T & T-Drive Gear Var BS15 VHH		
Nº	Size		
52422	Size 1 silver	var	500 - 650
52423	Size 2 silver	var	601 - 900
52425	Size 3 silver	var	901 - 1300
52426	Size 4 silver	var	1300 - 1800
for balkonery door			
52427	Size 5 silver	var	1851 - 2350
option balkonery door T&T Drive Gear lockable BS 30mm			
59494	Size 5 BS 30mm silver	var	1851 - 2350

3	Centre Lock		
Nº	Size		
54674	Size 400	751 - 1050	751 - 1050
54675	Size 528	1051 - 1300	1051 - 1300
54676	Size 628	1251 - 1500	1251 - 1500
52457	Size 828		1501 - 1750
52458	Size 1178		1751 - 1950
59920	Size 1678		1951 - 2350

Note: over SRW + SRH 800mm you have to use centre looks

Robert Reisinger 20.07.2007

2	Tilt Lock Bolt	
Nº		
52432	for Windows	500 - 1800
52433	for Doors	1801 - 2350

Nº	Striker plates
34220	Striker (14)
26309	Shoot Bolt Striker (19)
25312	Night vent Striker (25)

Nº	Corner Support
52478	3mm positioning pin (9)
Nº	Pivot Post
52483	3mm positioning pin (10)